

LED STRIP - SINGLE COLOR

Check Points:

1. Please check the lamp carefully before the installation.
2. Ensure the power is off before wiring and installation.

How to Choose a Power Supply

Tips

1. Please be kindly informed that the total wattage of LED strip lights should not exceed the max wattage of the adaptor you chose.
2. All the Adapters mentioned in this User Guide have only one DC output terminal. Thus they can only be used for one single strip light or a strip connected in series.
3. To guaranty the lighting uniformity of both the front and the end of the strip light, please do not connect the led strip light more than 5m.
4. If you want to use several strip lights together, please connect them in parallel and choose another adapter with more than one output terminal.

HOW TO INSTALL

STEP 1

If you want cut this strip light, please refer to the detail instructions of **LED Strip DIY(following)**.

STEP 2

Tear off the covering of the adhesive back of LED strip light.

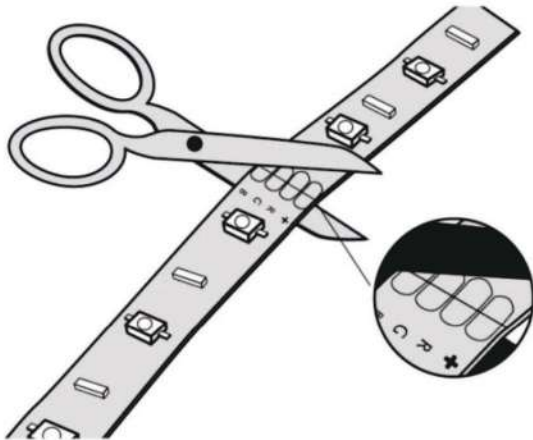

Please cut the LED strip through the lines marked on it.

How to connect the LED strip in series

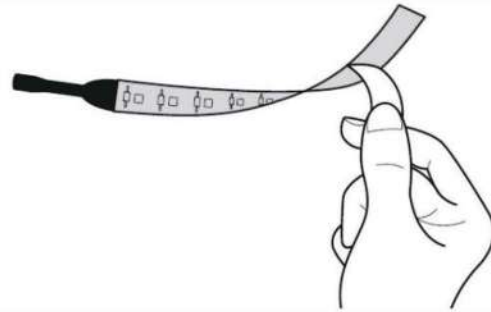

STEP 3

Stick up the adhesive strip onto where you want to use it.

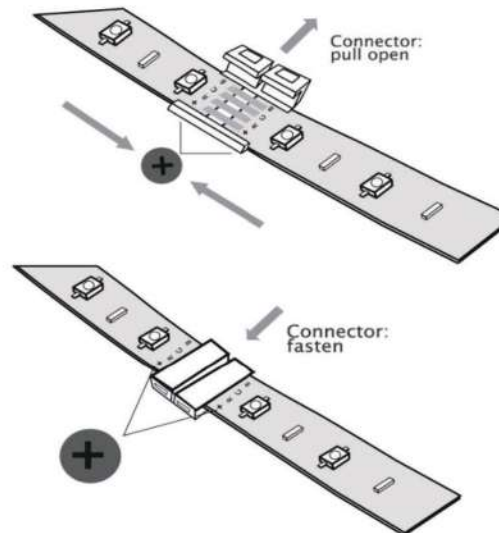
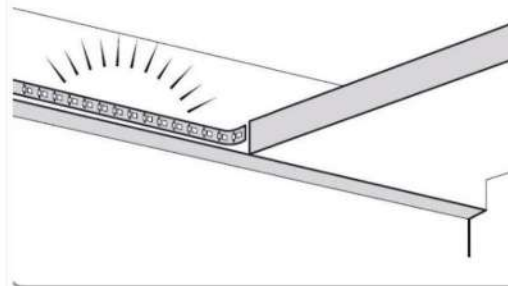

1. Please prepare two or more LED strips, and make sure the total wattage of LED strips should not exceed the max wattage of the adaptor you chose.
2. Please prepare another adapter with more than one output terminal. (All the Adapters mentioned in this User Guide have only one DC output terminal)
3. Please ensure that all the LED strips you want to be connected in parallel should be equipped with a DC port.
4. If a LED strip without any DC port, please equip it with the DC cable (included in the packing box). Please also make sure the positive and negative should be connected correctly.
5. When all the strips are equipped with a DC port, connect them directly into the adapter for more than one terminal.

STEP 4

Connect the LED strip and adapter with remote controller box, and then insert the DC plug of adapter into the remote controller box. At last connect another plug of adapter into the main socket to power it on.

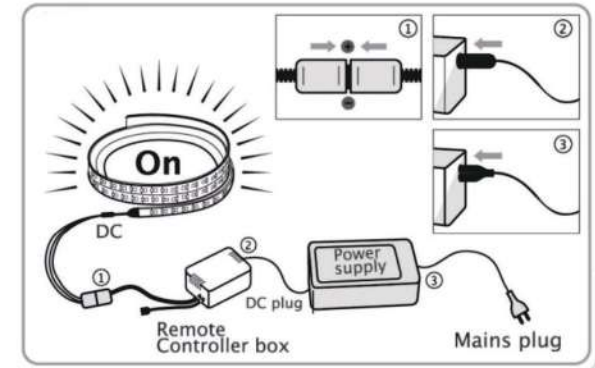

LED Strip DIY

How to cut the LED strip

How to connect LED strip lights in parallel

1. Please prepare two or more LED strips, and make sure the total wattage of LED strips should not exceed the max wattage of the adaptor you chose.
2. Please prepare a multi-ports adapter. (All the Adapters mentioned in this User Guide have only one DC output terminal)
3. Please ensure that all the LED strips be equipped with the remote controller box.
4. When all the strips are equipped with the remote controller boxes, connect them into the multi-ports adapter.
5. Connect the multi-ports adapter into main sockets to power it on.